

Surgical Dexterity Practice



Disclaimer

A series of booklets has been developed by the Clinical Skills Lab team (staff, recent graduates and students) from the School of Veterinary Sciences, University of Bristol, UK.

Please note:

- Each booklet illustrates one way to perform a skill and it is acknowledged that there are often other approaches. Before using the booklets students should check with their university or college whether the approach illustrated is acceptable in their context or whether an alternative method should be used.
- The booklets are made available in good faith and may be subject to changes.
- In using these booklets you must adopt safe working procedures and take your own risk assessments, checked by your university, college etc. The University of Bristol will not be liable for any loss or damage resulting from failure to adhere to such practices.

This work is under the Creative Commons Attribution-NonCommercial-NoDerivatives 4.0 International License.



© The University of Bristol, 2017



University of
BRISTOL

Year Group: BVSc3 +



Equipment for this station:

- The 'Box of Tricks'
- Beads (in pot in box)
- Surgical instruments
- Gloves
- A pen

N.B. Original 'Surgical Box' idea courtesy of Dan Smeak

Considerations for this station:

- This station can be used in conjunction with the gloving stations ('CSL_SP02 Closed Gloving' and 'CSL_SP03 Open Gloving') to practise dexterity with the added difficulty of the gloves decreasing the sensitivity of your fingers.
- It is recommended that this station is used in conjunction with the 'CSL_SP05 Surgical Instruments' station to ensure instruments are held correctly and to raise awareness of when different instruments are used.
- Surgical dexterity requires repeated practice, so don't be disheartened if you find it quite difficult the first time!

Anyone working in the Clinical Skills Lab must read the 'CSL_I01 Induction' and agree to abide by the 'CSL_I00 House Rules' & 'CSL_I02 Lab Area Rules'

Please inform a member of staff if equipment is damaged or about to run out.



Clinical Skills: Surgical Dexterity Practice 1: Use of surgical scissors

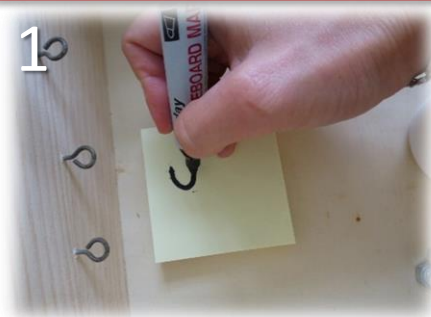

1 Use the marker pen to draw the outline of a circle approximately 2cm in diameter, in the centre of the post-it note. Also draw the outline of a square with each side about 1cm long at the edge of the post-it note.



2 Select the appropriate surgical instruments for the task. Refer to the booklet: 'CSL_SP05 Surgical Instruments' for information on how to handle instruments.



3 Working with your hands between the two rubber tubes, and without touching them throughout the task, use a pair of forceps to grasp a single sheet of the post-it note pile. You may wish to experiment with the different forceps to determine which is best for this type of delicate work.

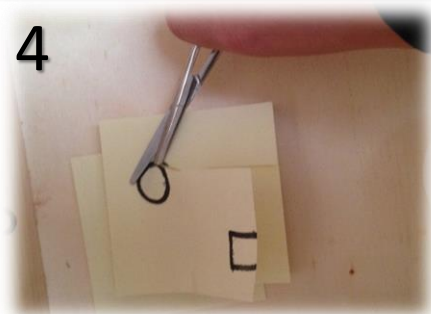

4 Carefully use the Metzenbaum scissors to cut out the circle shape from the sheet. Use the forceps to hold the post-it note sheet still.

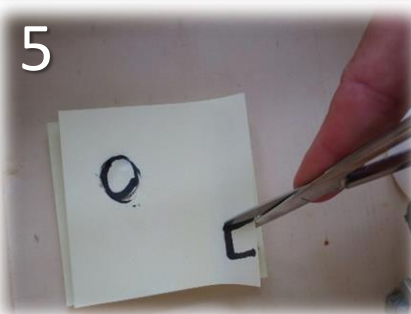

5 Next try cutting out the square shape from the same sheet, using the Metzenbaum scissors and the forceps to hold the post-it note sheet still.

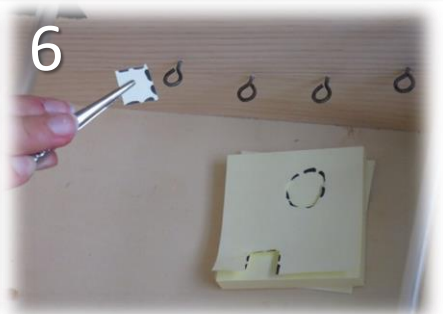

6 Use the instruments to remove the two small cut shapes from the box, and place them on the tray next to the box.





Clinical Skills: Surgical Dexterity Practice 2: Use of surgical forceps

1



Select the appropriate surgical instruments.

2



Working with your hands between the two plastic tubes, and without touching them throughout the task, use the instruments to pick up a bead from the pot.

3



Transfer the bead into the empty pot without touching the sides or the plastic tubing. Repeat this process for every bead.

4



Use the surgical instruments to pick up a fish hook from the pot, again without touching the pot sides.

5



Move the hook to the back of the box and hang it on a ring or embed it in the black velcro pad to the left or right, moving carefully under the plastic tubing.

6



Finally, reverse the process so that the hooks and beads end up back in the original pot. Remember to ensure the sides of the pots and plastic tubes are not touched at any point during the process.



University of
BRISTOL

Resetting the station: Surgical Dexterity Practice

1. Place beads back into the main central pot
2. Place hooks back into the main central pot
3. Rip off the used post-it note, leaving a fresh sheet on top
4. Replace all the instruments in the container/s provided

Station ready for the next person:



Please inform a member of staff if equipment is damaged or about to run out.



University of
BRISTOL

I wish I'd known:

Surgical Dexterity Practice

- Holding the instrument in the correct way is essential to assist the user's dexterity (see 'CSL_SP05 Surgical Instruments' for further instructions).
- Holding instruments correctly makes you 'look like a surgeon' – or not if you handle them incorrectly!